

Connector 7-16 female for RADIAFLEX® 78-50

Product Description

These single-piece high performance coaxial cable connectors are designed specifically to provide the highest quality connector-cable interface while simplifying and speeding up the attachment of connectors to RADIAFLEX® cables. The connectors provide outstanding value to users because they permit quick, easy and reliable installation at any location, thereby allowing the operator flexibility while saving installation time and money. They attach to prepared cable in one piece assuring error-free attachment. All connectors are fully tested for mechanical and electrical compliance specifications. They are available in all popular cable sizes in both type N and 7-16 DIN interface.



RADIAFLEX connector

Features/Benefits

- **Single-piece design for Fast and Easy Installation**

Reliable and simple attachment avoids unnecessary connector adjustments and provides outstanding performance. Saves time and provides cost savings.

- **Robust Mechanical Design**

Low and consistent IM performance.

- **Excellent Electrical Performance**

Low VSWR

- **Totally Waterproof**

Assures safe, long term operation in the harshest of environments.

Technical Specifications

Transmission Line Type	Coaxial Cable
Cable Size	7/8"
Cable Type	Radiating
Mating Interface	7-16 DIN
Connector Type	Straight
Sealing Method	Shrinking Sleeve
Gender	Female
Plating Outer/Inner	Brass/Bronze
Length, mm (in)	67.9 (2.67)
Outer Diameter, mm (in)	34.0 (1.33)
Weight, kg (lb)	0.17 (0.37)
Inner Contact Attachment	Spring Finger
Outer Contact Attachment	Spring loop
Maximum Frequency, GHz	3.7
VSWR (Return Loss) for DC < f ≤ 1.0GHz	1.03:1 (36.6 dB)
VSWR (Return Loss) for 1.0 < f ≤ 2.7GHz	1.06:1 (30.7 dB)
VSWR (Return Loss) for 2.7 < f ≤ 3.7GHz	1.08:1 (28.3 dB)
Waterproof Level	IP68

Notes

Other Documentation

Installation Instruction: [2800118-C_Inst Con_RA78-114-158_Con. 015 and 016 series.pdf](#)



Connector 7-16 female for RADIAFLEX® 78-50

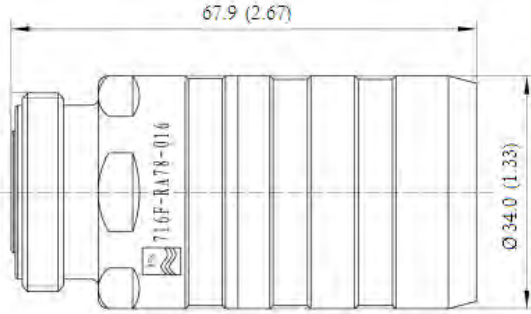

All information contained in the present datasheet is subject to confirmation at time of ordering